

LIMITED ONE-YEAR WARRANTY

Product Warranty Duration: All materials and workmanship are warranted to the original consumer purchaser for a period of one (1) year from the original purchase date.

Warranty Coverage: This product is warranted against defective materials or workmanship. This warranty is void if the product has been damaged by accident, in shipment, unreasonable use, misuse, neglect, improper service, commercial use, repairs by unauthorized personnel or other causes not arising out of defects in materials or workmanship.

This warranty is effective only if the product is purchased and operated in the USA, and does not extend to any units which have been used in violation of written instructions furnished with this product, or to units which have been altered or modified or to damage to products or parts thereof which have been altered, defaced or rendered illegible.

Warranty Disclaimers: This warranty is in lieu of all warranties expressed or implied and no representative or person is authorized to assume for this item any other liability in connection with the sale of our products. There shall be no claims for defects or failure of performance or product failure under any theory of tort, contract or commercial law including, but not limited to, negligence, gross negligence, strict liability, breach of warranty and breach of contract. Some states do not allow the exclusion or limitations of implied warranties or consequential damages, so the above limitations may not apply to you.

Greystone Brands Ltd. is not responsible or liable for indirect, special or consequential damages arising out of or in connection with the use or performance of the product or other damages with respect to loss of property, or loss of revenues or profit.

Legal Remedies: This warranty gives you specific legal rights and you may also have other rights that vary from state to state.

Warranty Performance: During the above one-year warranty period, a product with a defect will be either repaired or replaced with a reconditioned comparable model (at Greystone Brands Ltd. option). Contact support@greystonebrands.com for return authorization.

The repaired or replacement product will be in warranty for the balance of the one-year warranty period. No charge will be made for such repair or replacement.

Service and Repair: Should the appliance malfunction, you should email

support@greystonebrands.com stating that you are a consumer with a problem. Please include the Model Number of your product, the date of purchase and a description of the problem you are having.

In-Warranty Service: For product covered under the warranty period there is no charge made for service and shipping. Contact support@greystonebrands.com for a return authorization.

Out-of-Warranty Service: There will be charges rendered for repairs made to the product after the expiration of the one (1) year warranty period. After the purchaser is advised appropriately and accepts the service charge please include US \$15 for return shipping and handling to the service department.

Greystone Brands Ltd. cannot assume responsibility for loss or damage during incoming shipment of returned product. For your protection, carefully package the product for shipment and insure it with the carrier. Be sure to enclose the following items with your unit:

- Any accessories related to your problem
- Your full return address and daytime phone number
- A note describing the problem you experienced
- A copy of your sales receipt or other proof of purchase to determine the warranty status.

Any questions or comments can be directed to Greystone Brands Ltd by E-Mailing to support@greystonebrands.com

Or by calling our toll free # 888-430-1402

Or write to:

Greystone Brands Ltd 736 N. Western Ave • Suite 329 • Lake Forest, IL 60045
www.CleanJewels.com

NOTE: Product returns and COD shipments cannot be accepted at this address.

All Rights Reserved, Greystone Brands LLC REF # 0809

Printed in China

FRONTGATE®
OUTFITTING AMERICA'S FINEST HOMES®

JEWELRY SPA®



OWNER'S MANUAL
JW10

IMPORTANT SAFEGUARDS

When using electrical appliances, basic safety precautions should always be followed to reduce the risk of fire, electric shock, and/or injury to persons, including the following:

1. Read all instructions.
2. Do not touch hot surfaces. Use handles, tweezers and strainer.
3. When in use, the appliance is hot and should not be left unattended.
4. To protect against fire, electric shock, and injury to persons, do not immerse cord, plug, or appliance in water or other liquid. See instructions for cleaning.
5. This appliance is not intended for use by persons (including children) with reduced physical, sensory or mental capabilities, or lack of experience and knowledge, unless they have been given supervision or instruction concerning use of the appliance by a person responsible for their safety.
6. Close supervision is necessary when any appliance is used by or near children.
7. Unplug from outlet when not in use and before cleaning. Allow to cool before putting on or taking off parts, and before draining or cleaning the appliance.
8. Do not operate any appliance with a damaged cord or plug, or after the appliance malfunctions, or has been damaged in any manner. Contact Consumer Service for examination, repair or adjustment.
9. The use of accessory attachments not recommended by the appliance manufacturer may result in fire, electric shock, or injury to persons.
10. Use distilled water and the recommended cleaning solution only in this appliance! Do not use other liquids.
11. Do not use outdoors.
12. Do not let cord hang over edge of table or counter, or touch hot surfaces.
13. Do not place on or near a hot gas or electric burner, or in a heated oven.
14. To disconnect, press the ON/OFF button to turn the unit OFF, then remove plug from wall outlet.
15. Do not use appliance for other than intended use.

ADDITIONAL IMPORTANT SAFEGUARDS

WARNING: This appliance generates heat and escaping steam during use. Proper precautions must be taken to prevent the risk of burns, fires, or other injury to persons or damage to property.

1. All users of this appliance must read and understand this Owner's Manual before operating or cleaning this appliance.
2. The cord to this appliance should be plugged into a 120V AC electrical outlet only.
3. Never use this appliance without water. The use of distilled water is recommended.
4. Use water only in this appliance!
5. DO NOT attempt to move an appliance containing hot liquids. Allow appliance to cool completely before moving.
6. Keep appliance at least 4 inches away from walls or other objects during operation. Do not place any objects on top of appliance while it is operating. Place the appliance on a surface that is resistant to heat.
7. If this appliance begins to malfunction during use, press the ON/OFF button to turn the unit OFF, then immediately unplug the cord. Do not use or attempt to repair the malfunctioning appliance.
8. If this appliance falls or accidentally becomes immersed in water or any other liquid, unplug it immediately. **Do not reach into the water!** Do not use this appliance after it has fallen into or has become immersed in water. Contact Consumer Service for examination and repair.
9. DO NOT leave this appliance unattended during use.

NOTE: Please consult the Jewelry Cleaning Cycles Chart before beginning. Make sure the jewelry to be cleaned is able to withstand the electric CLEAN cycle. If not, then SOAK only and proceed to STEAM cycle.

CAUTION: Never remove jewelry by hand after cleaning. Always use tweezers to handle jewelry.

CAUTION: Never hold jewelry in your hand during the STEAM cycle. Always use tweezers to handle jewelry.

WARNING: Use only FRONTGATE® Jewelry Cleaning Concentrate Model # JW10C in the Jewelry Spa®

SAVE THESE INSTRUCTIONS

THIS PRODUCT IS FOR HOUSEHOLD USE ONLY

SHORT CORD INSTRUCTIONS

A short power-supply cord is provided to reduce the risk resulting from becoming entangled in or tripping over a longer cord.

Do not use an extension cord with this product. Always plug directly into a wall outlet/receptacle.

PLASTICIZER WARNING

CAUTION: To prevent Plasticizers from migrating to the finish of the countertop or tabletop or other furniture, place NON-PLASTIC coasters or placemats between the appliance and the finish of the countertop or tabletop.

Failure to do so may cause the finish to darken, permanent blemishes may occur or stains can appear.

POLARIZED PLUG

This appliance has a polarized plug (one blade is wider than the other). To reduce the risk of electric shock, this plug is intended to fit into a polarized outlet only one way. If the plug does not fit fully in the outlet, reverse the plug. If it still does not fit, contact a qualified electrician. Do not attempt to modify the plug in any way.

ELECTRIC POWER

If the electrical circuit is overloaded with other appliances, your appliance may not operate properly. It should be operated on a separate electrical circuit from other appliances.

Warning

TO REDUCE THE RISK OF FIRE OR ELECTRIC SHOCK, DO NOT REMOVE THE BOTTOM COVER. NO USER-SERVICEABLE PARTS INSIDE. REPAIR SHOULD BE DONE BY AUTHORIZED SERVICE PERSONNEL ONLY.

GETTING TO KNOW YOUR JEWELRY SPA®

PRODUCT MAY VARY SLIGHTLY FROM ILLUSTRATIONS

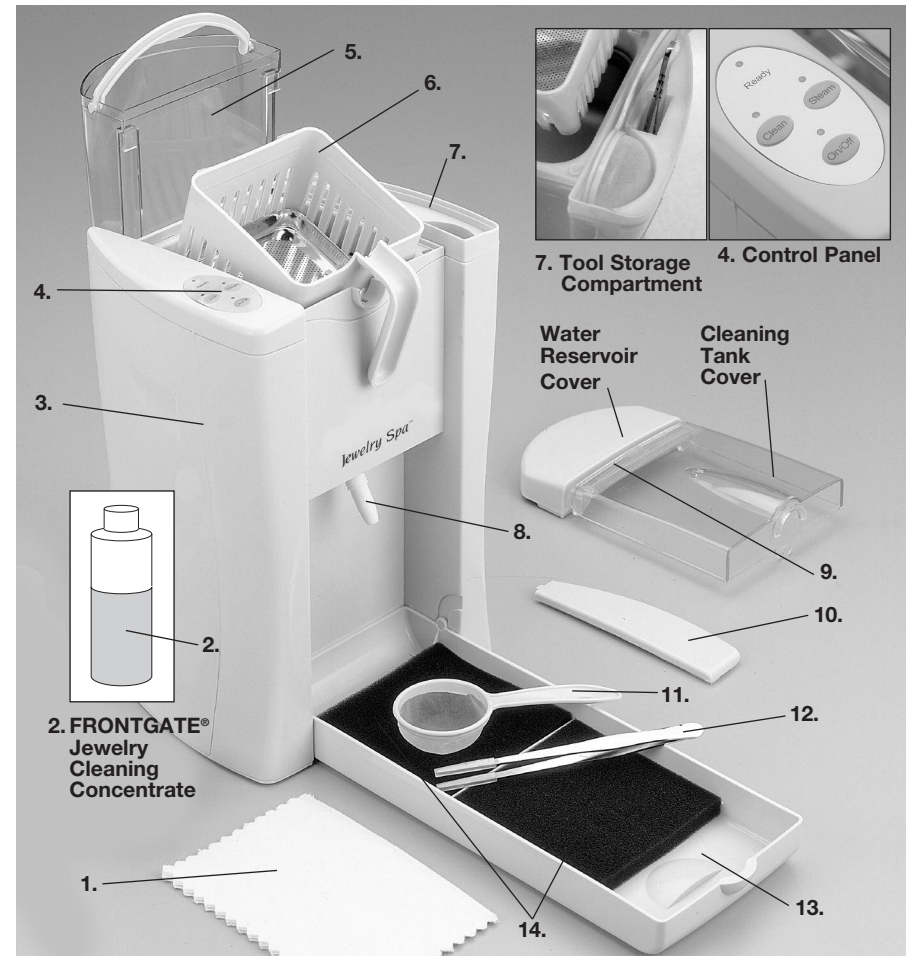

Figure 1

1. Polishing Cloth (P/N 10067)
2. FRONTGATE® Jewelry Cleaning Concentrate (P/N JW10C) SOLD SEPARATELY
3. Stainless Steel Cleaning Tank (inside)
4. Control Panel
5. Removable Water Reservoir with Handle (P/N 10062S)
6. Jewelry Cleaning Basket with Handle (P/N 100645)
7. Tool Storage Compartment
8. Steam Nozzle
9. Hinged Safety Cover (P/N 10063S)
10. Storage Compartment Lid (P/N 10057S)
11. Strainer (P/N 10059S)
12. Tweezers (P/N 10058)
13. Removable Catch Basin (P/N 10060S)
14. Sponges (P/N 10061)

Before Using for the First Time

CAUTION: To protect against electric shock, do not immerse the Jewelry Spa® or allow power-supply cord to come into contact with water or other liquids.

1. Carefully unpack Jewelry Spa®, all parts and tools.

NOTE: Tools are packed in the storage compartment on the right side of the Jewelry Spa®. (See Figure 1.)

2. Remove any packing materials.
3. Wipe the unit with a soft, clean cloth or sponge.
4. **Assemble the Jewelry Spa®.** Make sure the removable water reservoir is in position at the back of the Jewelry Spa®. Lower the jewelry cleaning basket into the cleaning tank. Place the hinged safety cover on top. Place tools: tweezers and strainer into the storage compartment. (See Figure 1.)
5. Make sure all components: safety cover, removable catch basin with sponges, removable water reservoir, and jewelry cleaning basket are properly assembled and securely in place.

OPERATING INSTRUCTIONS

IMPORTANT: We recommend the use of FRONTGATE® Jewelry Cleaning Concentrate in your Jewelry Spa®. This concentrated cleaner is made with all natural ingredients, it is non-toxic and bio-degradable.

CAUTION! CONCENTRATED SOLUTION: Keep out of reach of children. See Label warnings for detailed instructions in case of contact.

NOTE: Please consult the Jewelry Cleaning Cycles Chart before beginning. Make sure the jewelry to be cleaned is able to withstand the electric CLEAN cycle. If not, then SOAK only and proceed to STEAM cycle.

1. Place the assembled Jewelry Spa® on a flat, firm surface, preferably near a sink, on a countertop in your kitchen or bathroom.
2. Plug the Jewelry Spa® directly into a 120V AC electrical outlet. Do not use an extension cord with this product.
3. Open the back half of the hinged safety cover and fill the water reservoir with **DISTILLED WATER ONLY**. (See Figure 2.) Close cover.



Figure 2

WARNING: If tap water is used, a white film or haze will spot the jewelry or gems when the water dries after the STEAM cycle.

4. Open the front half of the hinged safety cover to reveal the stainless steel cleaning tank.
5. Remove jewelry cleaning basket.
6. Fill the cleaning tank with DISTILLED WATER ONLY to the FILL line on cleaning tank wall, approximately 1/2 inch from top of tank. (See Figure 3.)
7. For normal jewelry cleaning, add 1 oz. (2 Tbsp) FRONTGATE® Jewelry Cleaning Concentrate to the cleaning tank. For extra-difficult cleaning jobs, use up to 2 oz. (4 Tbsp).



Figure 3

NOTE: A stronger bath will not harm jewelry or gems being cleaned.

NOTE: ALWAYS add distilled water BEFORE adding FRONTGATE® Jewelry Cleaning Concentrate.

8. Close cleaning tank part of safety cover.

Soaking and the Electric CLEAN Cycle

NOTE: Please consult the Jewelry Cleaning Cycles Chart before beginning. Make sure the jewelry to be cleaned is able to withstand the electric CLEAN cycle. If not, then SOAK only and proceed to STEAM cycle.

NOTE: Make sure jewelry to be cleaned is at room temperature before immersing in cleaning tank.

1. With the water and FRONTGATE® Jewelry Cleaning Concentrate added to the cleaning tank, press the ON/OFF button once. The red power ON indicator light will illuminate. The green READY light will illuminate almost immediately, indicating STEAM is building. Jewelry may be soaked and cleaned at any time, however, for objects that require more thorough cleaning, allow 10 to 15 minutes for the cleaning tank to reach CLEAN cycle temperature.



Figure 4

2. Lift the front half of the hinged safety cover to reveal the cleaning tank. Rest the jewelry cleaning basket on the front of the cleaning tank. Place jewelry or multiple pieces of jewelry into the jewelry cleaning basket so that each piece of jewelry makes contact with the gold-plated portion of the jewelry cleaning basket. (See Figure 4.)



Figure 5

NOTE: Do not allow jewelry to extend through the sides of the jewelry cleaning basket and make contact with the cleaning tank. For the electric CLEAN cycle to be effective, jewelry must make contact with the gold-plated portion of the jewelry cleaning basket.

3. Lift the jewelry cleaning basket from the resting position and submerge it in to the cleaning bath. (See Figure 5.) Make sure that the 2 tabs extending out from the jewelry cleaning basket line up with the 2 inserts extended off the back wall of the cleaning tank for proper alignment with electrical contacts. Close the safety cover to ensure a good connection with the contact points and lock the jewelry cleaning basket into place. (See Figure 6.)



Figure 6

NOTE: If your jewelry is of a type which is not recommended for the electric CLEAN cycle*: antiqued jewelry with black ink, chemically blackened Silver, Gold set with Marcasite or Gemstones, native American jewelry with Turquoise, inlaid or glued stones, **soak items for up to 60 seconds in the warm cleaning solution bath. DO NOT press the CLEAN button before proceeding to the STEAM cycle.**

4. Allow 10 to 15 minutes for the cleaning tank to reach optimal CLEAN cycle temperature. Press the CLEAN button to start the 60-second electric CLEAN cycle. The green CLEAN indicator light will illuminate. When finished, the CLEAN cycle will automatically shut itself OFF, the light will turn off. The first step of the cleaning is done.
5. Slowly open the front half of the hinged safety cover to reveal the cleaning tank. Lift the jewelry cleaning basket to the resting position on the front of the cleaning tank. Allow to drain completely before removing the soaked or cleaned jewelry for the STEAM cycle.

*Please consult the Jewelry Cleaning Cycles Chart.

See also: Examples of Jewelry NOT Recommended for Electric CLEAN Cycle.

CAUTION: Jewelry will be HOT. Never touch with bare hands. Always use tweezers for handling hot jewelry.

The STEAM Cycle

CAUTION: Always use tweezers, strainer, or cleaning basket for handling jewelry; jewelry and steam will be HOT.

1. Larger cleaned items may remain in the jewelry cleaning basket during the STEAM cycle. (See Figure 9.) For smaller items, use the tweezers supplied with your Jewelry Spa® and place into the strainer. (See Figure 7.) The tweezers should be used whenever the STEAM cycle is used. (See Figure 8.)

NOTE: For ease of use, always store tools in the convenient storage compartment of the Jewelry Spa®

2. Press the STEAM button while positioning the jewelry under the steam nozzle. (See Figure 7.) The green STEAM indicator light will illuminate. A stream of distilled water will be pumped into the dual port steam generator system.



Figure 7

CAUTION: Avoid contact with the steam nozzle. Some spurts of dry steam vapor may be emitted, this is normal.

3. Approximately 10-15 seconds after pressing the STEAM button, a burst of wet steam will sterilize and rinse the jewelry item.
4. Use the tweezers to help direct the steam into the areas where it is needed to push out residual dirt and grime from the soaking/electric cleaning process.
5. The pump will automatically shut itself OFF after 15 seconds. The STEAM indicator light will turn off.

NOTE: For difficult-to-clean items, and to enhance the STEAM cycle cleaning, fill the removable water reservoir with distilled water. Add 1/4 oz. (1/2 Tbsp) FRONTGATE® Jewelry Cleaning Concentrate to the water reservoir.

NOTE: If there is still dirt and grime remaining in grooves, you can repeat the electric CLEAN cycle as many times as needed to remove dirt and grime.

NOTE: Please consult the Jewelry Cleaning Cycles Chart for exceptions.

6. If you require a burst of steam with more pressure, when the indicator light goes out, immediately press the STEAM button again.

NOTE: Due to changes in temperature during the heating process, variations may occur in the steam burst, this is normal.

NOTE: During periods of extended use, occasional puffs of steam may occur, this is normal.

NOTE: After completing the STEAM cycle, if there is still dirt and grime lodged in the grooves, repeat the STEAM cycle until all dirt and grime has been removed.

7. Press the ON/OFF Button to turn the Jewelry Spa® OFF, then remove plug from wall outlet.

Holding Jewelry during the STEAM Cycle

1. Hold jewelry with the tweezers to direct steam behind the stone to remove the soap, dirt and grime that becomes lodged in the setting. Allow the steam to push out residual dirt and grime after soaking and using the electric CLEAN cycle. (See Figure 8.)



Figures 8A - 8C. Use tweezers to hold diamond stud earrings, bangle bracelets or rings

2. Use the jewelry cleaning basket to hold large chains, pins, or bracelets during the STEAM cycle. Use the strainer to help with small jewelry items such as earrings, thin chains, charms. (See Figure 9.)



Figures 9A - 9C. Use the cleaning basket for larger items; the strainer for smaller pieces; tweezers allow the jewelry to be held safely at any angle under the steam.

How to Use the Polishing Cloth

Always clean jewelry in the Jewelry Spa® before polishing. To avoid scratching the highly polished surface of the jewelry by abrasive contaminants, do not bypass the STEAM cycle before using the polishing cloth.

1. Lay the polishing cloth down on a flat surface with the white inner cloth facing up. (See Figure 10.) The inner side of the cloth contains a polishing compound. Then with smooth, even strokes, slide the jewelry back and forth. This will help in brightening the high spots on the jewelry where it tends to become dulled by wear.
2. Next buff to a high luster with the outer cloth. (See Figure 11.)

NOTE: The outer cloth does not contain polishing compound.

3. Rinse the jewelry using the STEAM cycle of the Jewelry Spa® only. The steam will remove the black residue that remains from the polishing cloth's polishing compound and eliminate black rings from appearing around the finger, wrist, or neck.



Figure 10



Figure 11

Tip: You may find that after a first cleaning in the Jewelry Spa[®], soap or paint etc. deposits have hardened, for example: in the holes behind the gemstones, or in hard-to-reach crevasses in the backside of a ring, or in the link of a chain. To help break up the deposit, use a round toothpick dipped in the cleaning bath until it becomes soaked and somewhat soft. Press it on a hard surface until you see what looks like bristles on a small paint brush. (See Figure 11.) This is a perfect tool for getting into these areas. Repeat the electric CLEAN cycle* and then the STEAM cycle in the Jewelry Spa[®].



Figure 12

*Please consult the Jewelry Cleaning Cycles Chart for exceptions.

SIMPLE GUIDE TO JEWELRY CLEANING

Metals that can be cleaned: Platinum, Gold, Sterling Silver, Titanium, and Stainless Steel.

Precious gemstones that can be cleaned: Diamond, Emerald, Ruby, and Sapphire.

Semiprecious gemstones that can be cleaned: Agate, Alexandrite, Amethyst, Aquamarine, Azurite, Bloodstone, Carnelian, Cat's Eyes, Chalcedony, Chrysoberyl, Citrine, Garnet, Iolite, Jade, Jasper, Kunzite, Lapis Lazuli, Marcasite, Malachite, Moonstone, Onyx, Opal, Peridot, Quartz, Spinel, Tanzanite, Topaz, Tourmaline, Turquoise, and Zircon.

Semiprecious Organic Gemstones / Soft that can be cleaned: Pearl, Coral, Ivory, Shell (Cameo) can be cleaned in the Jewelry Spa[®] using all 3 cycles but can only be immersed for one 60-second cycle in the electric cleaning bath.

IMPORTANT: DO NOT allow Organic Gemstones to soak in the cleaning bath for an extended length of time. This will dull the luster.

Artificial Gemstones that can be cleaned: Cubic Zirconia (CZ), Moissanite and all lab-created Gemstones.

IMPORTANT: NEVER clean Jet (fossilized wood) or Amber (fossilized resin of extinct trees) in the Jewelry Spa[®].

IMPORTANT: Jewelry with inlayed Opal, Onyx, or Mother of Pearl that are held by a form of glue, have Enameling or colored Epoxy can only soak for 60-seconds or less. **DO NOT use the electric CLEAN cycle. Use the STEAM cycle from a minimum distance of 2 inches from the steam nozzle.**

To better understand the terminology in our Simple Guide to Jewelry Cleaning, please consult the Glossary that follows.

Jewelry Cleaning Cycles

Type of Jewelry	Soak	Electric CLEAN	STEAM
Platinum Plain also Platinum with Precious, Semiprecious, Artificial or Organic Gemstones	x	x	x
Platinum with Precious, Semiprecious, Artificial or Organic Gemstones with Antique Finish (Black) or Antique Finish (Black) Only	x	NO	x
Gold Plain Yellow, White or Pink also Gold Yellow, White or Pink with Precious, Semiprecious, Artificial or Organic Gemstones 10 Karat, 14 Karat, 18 Karat, 22 Karat, etc.	x	x	x
Gold Yellow, White or Pink with Precious, Semiprecious, Artificial or Organic Gemstones with Antique Finish (Black) or Antique Finish (Black) Only 10 Karat, 14 Karat, 18 Karat, 22 Karat, etc.	x	NO	x
Sterling Silver Plain also Sterling Silver with Precious, Semiprecious, Artificial or Organic Gemstones	x	x	x
Sterling Silver with Precious, Semiprecious, Artificial, Organic Gemstones also Marcasite with Antique Finish (Black) or Antique Finish (Black) Only	x	NO	x
Titanium Plain also Titanium with Precious, Semiprecious, Artificial or Organic Gemstones	x	x	x
Titanium with Precious, Semiprecious, Artificial or Organic Gemstones with Antique Finish (Black) or Antique Finish (Black) Only	x	NO	x
Stainless Steel Plain also Stainless Steel with Precious, Semiprecious, Artificial or Organic Gemstones	x	x	x
Platinum, Gold, Sterling Silver, Titanium or Stainless Steel with inlayed Opal, Onyx, Mother of Pearl, that are being held in by a form of glue or have Enameling or colored Epoxy	x	NO	x
Pearl Strands	x	x	x

Examples of Jewelry NOT Recommended for Electric CLEAN Cycle. SOAK ONLY.



GLOSSARY

Platinum

A silver-white highly reflective precious metal. One of the main advantages of platinum for jewelry fabrication is its strength and resistance to tarnish.

Gold

A soft, yellow, corrosion-resistant metal, gold is generally alloyed to increase its strength, we call that Karat Gold (Karat) is a unit of measure for the fineness (purity) of gold, equal to 1/24 part. Pure gold is 24 karat; gold that is 50 percent pure is 12 Karat or 50.0, 10 Karat or 41.7 , 14 Karat or 58.5, 18 Karat or 75.0, 22 Karat or 91.3.

Silver - Sterling Silver

A lustrous white metallic element. It is highly valued for jewelry, tableware, and other ornamental use and is widely used in coinage, photography, dental and soldering alloys, electrical contacts, and printed circuits. Sterling Silver is an alloy of 92.5 percent silver with copper or another metal. That is why Sterling Silver is stamped 925.

Titanium

A strong, low-density, highly corrosion-resistant, lustrous gray-white metallic element that is used to alloy aircraft metals for low weight, strength, and high-temperature stability. Now also used in jewelry manufacturing with gemstones.

Stainless Steel

Various steels alloyed with at least 10 percent chromium and sometimes containing other elements and that are resistant to corrosion or rusting associated with exposure to water and moist air.

Gemstone

A precious or semiprecious stone that may be used as a jewel when cut and polished. Most gemstones are minerals that have formed in a variety of environments within the earth. Ideally gemstones should be hard and unaffected by the temperatures pressures, abrasive dusts and chemicals encountered in our everyday lives.

Precious

Of high cost or worth; valuable.

Semi-Precious

Half. Partial; partially. Resembling or having some of the characteristics of precious.

Organic

Plants and animals are the sources of the more fragile 'organic' gems that have been used for ornament since ancient times. Jet and Amber are the fossilized wood and resin of extinct trees, while pearls shells and most corals are calcium carbonate structures formed by aquatic animals. Ivories are the tusks and teeth of land and sea mammals.

Artificial Gems

Man-made; produced rather than natural. Made in imitation of something natural; simulated. Not genuine or natural. The demand for rare gemstones has led to the production of countless imitations, some more successful than others.

These copies fall into 3 categories:

1. Gems that look like they are real, but have a different composition;
2. Synthetic gems, which are made in laboratories and are almost exact copies of natural gems;
3. Composite stones, which consist of several parts cemented together.

Antique Finish

To give the appearance of an antique. Black Indian ink is applied to the jewelry and allowed to dry. The high spots are wiped with a solvent, leaving the shiny metal exposed giving the jewelry an old appearance.

Enameling

A decorative finish which usually has the appearance of a candy apple. Fired in a kiln, the enamel finish comes in an array of bright colors.

USER MAINTENANCE INSTRUCTIONS

This appliance requires little maintenance. It contains no user serviceable parts. Do not try to repair it yourself. Any servicing that requires disassembly must be performed by a qualified appliance repair technician.

CAUTION: Always unplug Jewelry Spa® from electrical outlet when not in use and before cleaning. **Never immerse the Jewelry Spa®, its cord or plug in water or any other liquid.**

Daily Draining, Care and Cleaning

CAUTION: Always allow Jewelry Spa® and cleaning solution to cool down before preparing to drain for storage.

CAUTION: When lifting machine, always lift from both sides.

1. **Make sure the Jewelry Spa® is unplugged before draining and cleaning.**
2. Check the removable catch basin located at the front/bottom of the Jewelry Spa®. Water will accumulate in the sponges. Use care not to spill; carefully drain in the sink. Rinse and wring out the sponges before replacing.
3. Next, remove the safety cover and jewelry cleaning basket. Rinse with warm water and dry with paper towels or a soft towel.
4. Use the handle to lift the removable water reservoir up and out from the back of the Jewelry Spa®. The unused distilled water may be poured back into its original container for re-use.
5. Carefully drain the cleaning solution from the stainless steel cleaning tank into the sink using the built-in spout. (See Figure 13.)



Figure 13

NOTE: It is safe to pour the used FRONTGATE® Jewelry Cleaning Concentrate cleaning solution down household sink drains.

6. After draining, fill the cleaning tank with warm water and drain again. Dry with paper towels or a soft towel.
7. Rinse the tweezers and small strainer. Dry with paper towels or a soft towel. Place tools in the storage compartment for the next use.
8. When cleaning has been completed, thoroughly wash hands and any other areas of the skin exposed to the cleaning solution.

6-Month Cleaning: Stainless Steel Tank and Jewelry Cleaning Basket

Depending on frequency of use, or every 6 months, a build-up of dirt and grime may accumulate making it necessary to clean the stainless steel cleaning tank and the gold-plated jewelry cleaning basket. This cleaning will ensure good current flow when the electric CLEAN cycle is used.

1. **Make sure the Jewelry Spa® is unplugged before cleaning.**
2. Add white vinegar to the cleaning tank until it is half full.
3. Lower the empty jewelry cleaning basket into the cleaning tank. Fill the cleaning tank with DISTILLED WATER ONLY to the FILL line on cleaning tank wall, approximately 1/2 inch from top of tank.
4. Close the hinged safety cover.
5. Allow to soak overnight. This will clean stainless steel tank walls and gold-plated jewelry cleaning basket of dirt and grime.
6. Remove the jewelry cleaning basket and rinse under cool, clean water. Carefully drain the cleaning solution from the stainless steel cleaning tank into the sink using the built-in spout as shown in Figure 12.
7. The cleaning tank and basket will look brand new.

NOTE: Periodic cleaning of the electrical contacts on the jewelry cleaning basket and cleaning tank should be performed. Gently rub the contacts using a clean pencil eraser to remove any residue buildup. Keeping the contacts clean will provide higher efficiency cleaning during the electric CLEAN cycle. (See Figure 14 and Figure 15.)

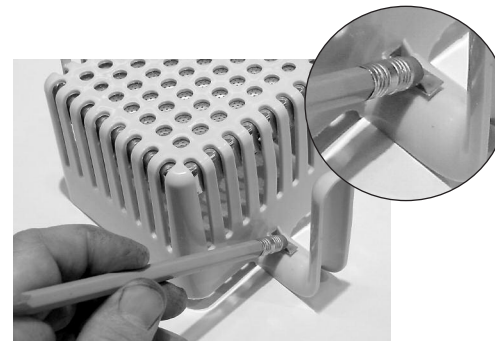

Figure 14



Figure 15

Storage Instructions

1. Unplug the Jewelry Spa® and allow the Jewelry Spa® and all liquids to cool completely.
2. Clean and drain the unit following the instructions outlined in the Daily Draining, Care and Cleaning section of this Instruction Manual.
3. Store the clean Jewelry Spa® in its box or in a cool, dry place.
4. Never store unit while it is still plugged in.
5. Never wrap cord tightly around the Jewelry Spa®. Do not put any stress on the cord where it enters the appliance as it may cause the cord to fray and break.